



## WORK LIGHTING KIT MKX, X, HX SERIES AUGERS INSTALLATION INSTRUCTIONS

These instructions apply to the following models:

MKX100 - 53', 63', 73', 83'

X100 - 63', 73', 83'

HX100 - 63', 73', 83'

MKX130 - 64', 74', 84', 94', 114'

X130 - 74', 84', 94', 114'

HX130 - 74', 84', 94'

MKX160 - 85', 105', 125'

X160 - 85', 105', 125'



Read and understand the safety information in the appropriate auger assembly manual before proceeding.



Read and understand the instructions in this manual before attempting to install this product.

### Pre-Installation Notes

The following instructions are for installing the kit during the assembly of a new auger.

To install the kit on an auger which has already been fully assembled, some disassembly will be required.

**Important:** To install the kit on a 73'/74' auger which has already been fully assembled, make sure to follow the "Important Notes" below.

#### Westfield | Wheatheart

part of the Ag Growth International group  
P.O. Box 39, Rosenort, Manitoba, R0G 1W0 Canada  
Ph: (866) 467-7207 or (204) 746-2396 Fax: (866) 768-4852  
Website: [www.grainaugers.com](http://www.grainaugers.com) | [www.wheatheart.com](http://www.wheatheart.com)  
Email: [sales@grainaugers.com](mailto:sales@grainaugers.com) | [sales@wheatheart.com](mailto:sales@wheatheart.com)

#### Hutchinson | Mayrath

part of the Ag Growth International group  
514 W. Crawford St., Clay Center, Kansas, 67432 USA  
Ph: (800) 523-6993 or (785) 632-2161 Fax: (785) 632-5964  
Website: [www.hutchinson-mayrath.com](http://www.hutchinson-mayrath.com)  
Email: [sales@hutchinson-mayrath.com](mailto:sales@hutchinson-mayrath.com)

© Ag Growth International Inc. 2018

PART NUMBER: 30997 R2

REVISED: 28/11/18

## Installation Procedure

The lighting kit consists of one flood lamp, two mini-flood lamps, a wiring harness, a fused light switch box, a mounting bracket, cable ties, and hardware.

1. Secure the axle-area lamp bracket:



- **53'/63'/64'/83' models:** to the tube flange using the existing hardware (see Figure 1.1).



- **73'/74' models:** between the truss tower and the middle tube using two 7/16" x 1-1/4" bolts (for 73') or 7/16" x 1-1/2" bolts (for 74') and locknuts (see Figure 1.1).



- **84'/94'/114' models:** to the truss tower using the existing cable clamp and a 5/16" flat washer (see Figure 1.2).



- **85'/105'/125' models:** to the truss tower using the existing cable clamp (see Figure 1.2).

2. Fasten the axle-area mini-flood lamp to the bracket.
3. Fasten the discharge-area flood lamp to the upper tube.
4. Fasten the swing hopper mini-flood lamp to the swing tube.
5. Route the wiring harness along the truss cable and secure using zip ties. Plug the wiring harness connectors into the lamp connectors. Ensure that the connectors are fully engaged.
6. Install the switch box on the boot using two #8 x 3/4" Tek screws.

## Important Notes for 73'/74' Models

If you are installing the lighting kit on 73'/74' auger which has already been fully assembled, step 1 of the Installation Procedure requires the truss tower be removed in order to install the axle-area lamp bracket. To remove the truss tower, the truss cables must be loosened. Prior to loosening the truss cable, make sure to support the auger's upper tube within 1' of the cable return bracket. The tube may be supported using a lifting sling or a front-end loader, while ensuring the tube paint is not damaged. After the axle-area lamp bracket is installed, make sure to re-tighten the cable according to the procedure in the auger manual.

**NOTICE** If the auger tube is not supported when the truss cable is loosened, the auger will be damaged due to bending.

**Figure 1.1 Representation of Installation for 53'-83' Models**

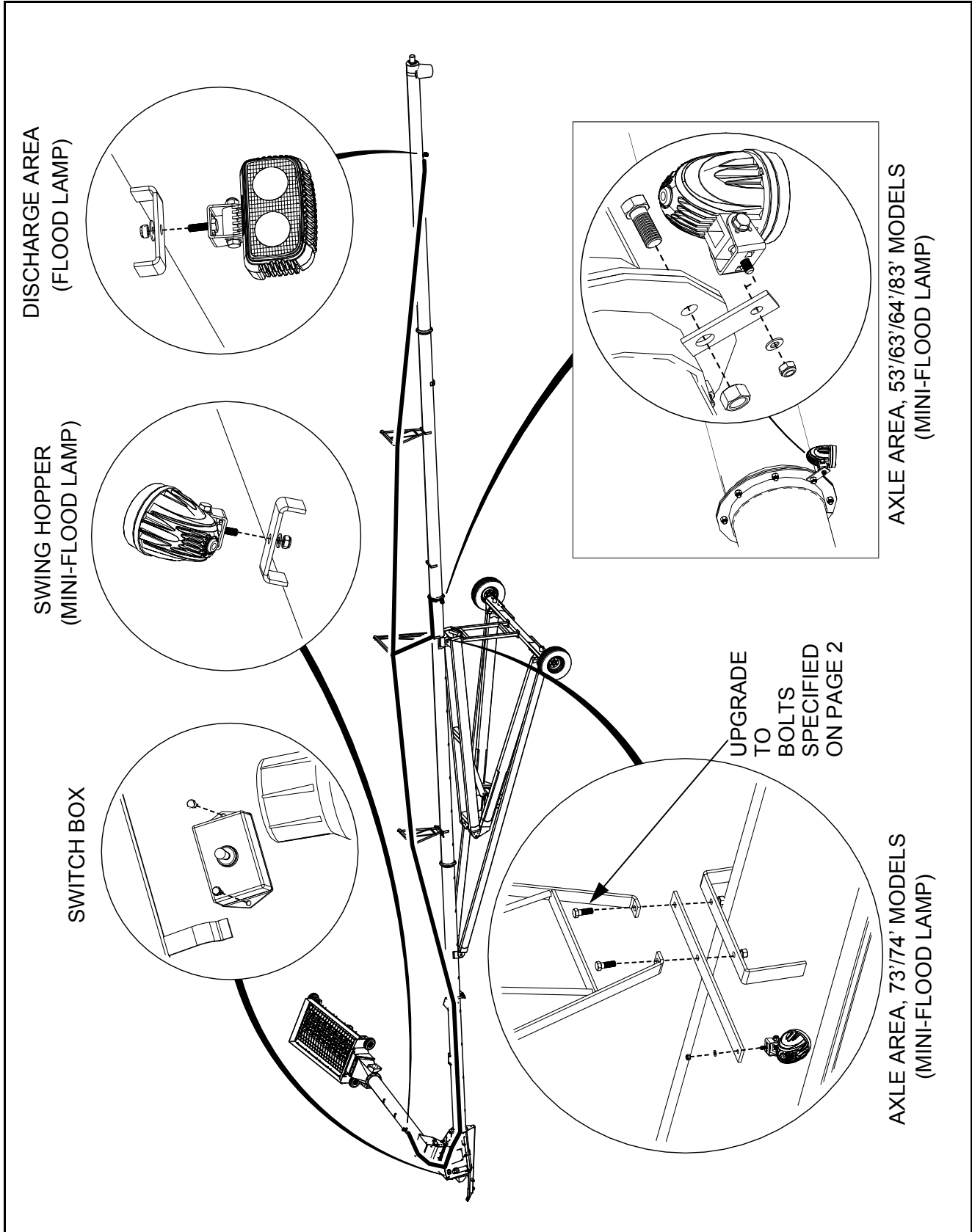

Figure 1.2 Representation of Installation for 84'-125' Models

